

Optosource

Optical Reflector for Bridgelux Vero 13 COB

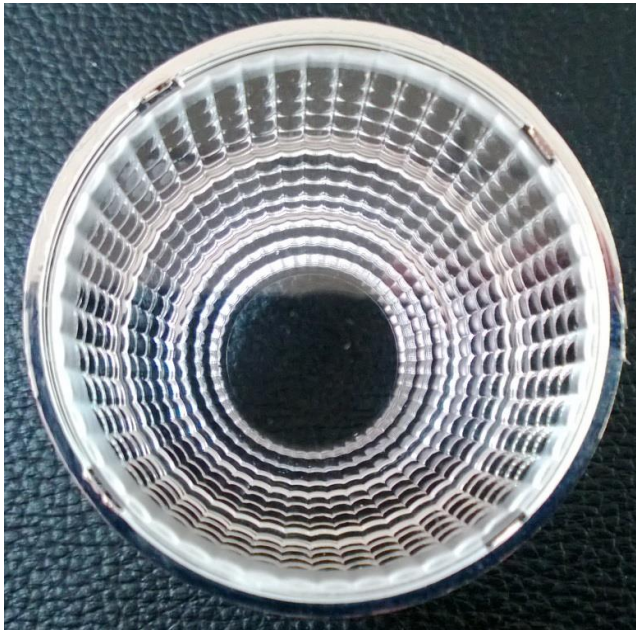

- Specially design for Bridgelux Vero 13 series LEDs.
- Reflector material metallized PC, with high UV and temperature resistance.
- Small position pins, fastening to Vero orifice with droplets glue.

Reflector Types

Order Code	FWHM Angle	Cover	Holder
BR05024-C1C-BV13	±12	With Cleaar Cover	Without Holder
BR05040-C1C-BV13	±20	With Cleaar Cover	Without Holder
BR05060-C1C-BV13	±30	With Cleaar Cover	Without Holder

Optosource

Measurements

Relative Intensity of BR05024-C1C-BV13

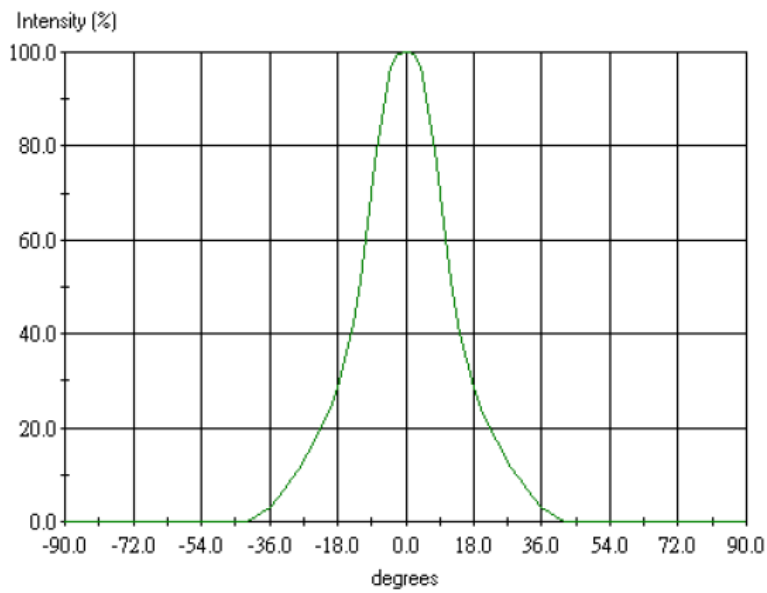

Relative Intensity of BR05040-C1C-BV13

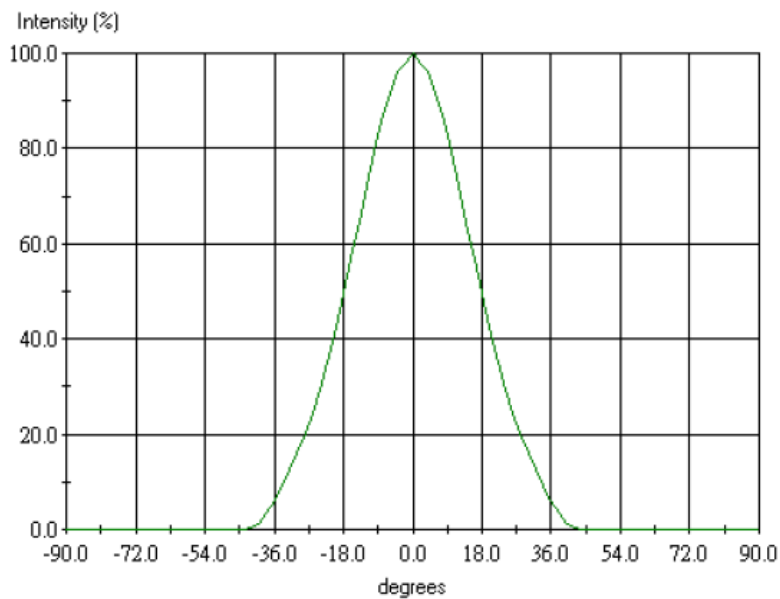

Optosource

Measurements

Relative Intensity of BR05060-C1C-BV13

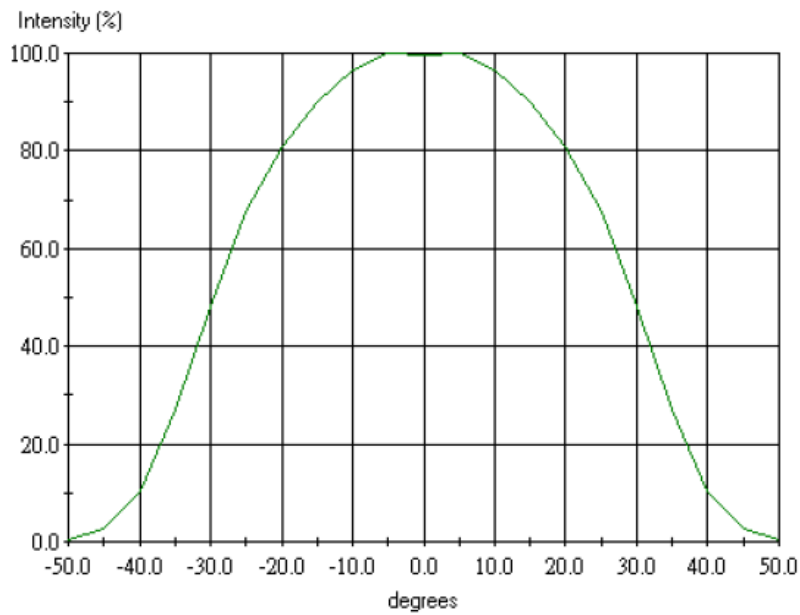

Optosource

Drawings

Reflector drawings

BR05024-C1C-BV13 / BR05040-C1C-BV13

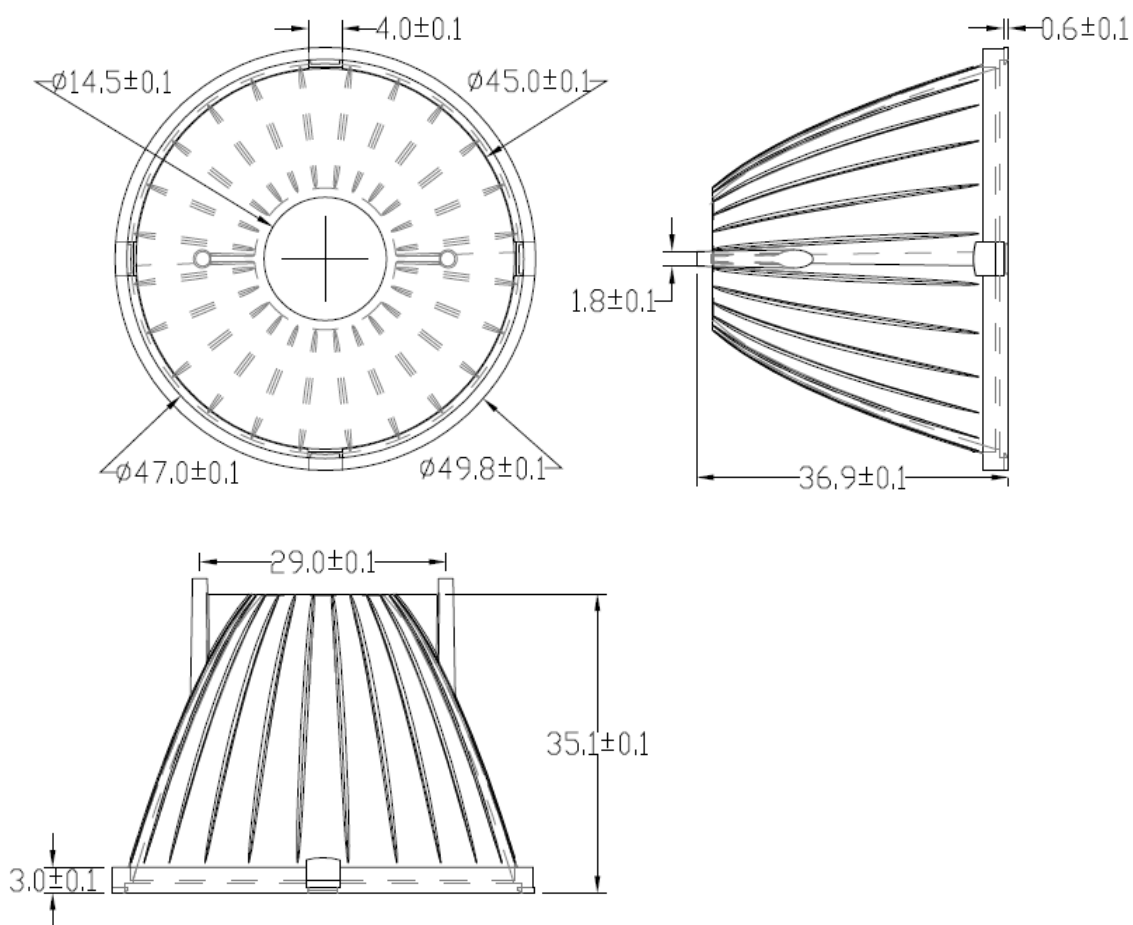

Optosource

Drawings

BR05060-C1C-BV13

